

Av. Irigoyen (Pav)

17,30

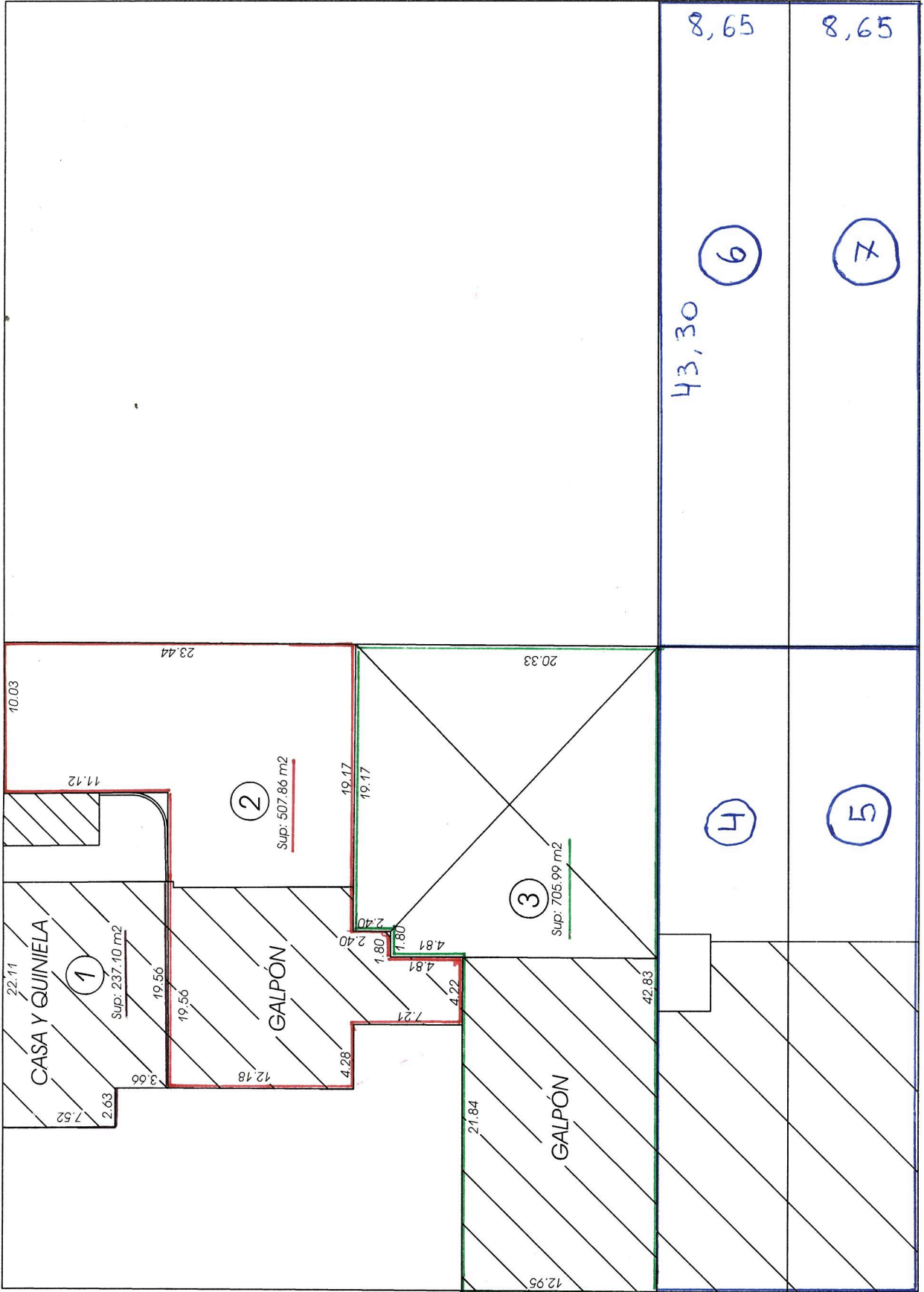

8,65

8,65

6

7

43,30

4

5

10,03

22,11

7,52

12,95

1

Sup: 237.10 m²

2,63

3,66

19,56

19,56

11,12

23,44

2

Sup: 507.86 m²

12,18

4,28

7,21

4,81

1,80

2,40

1,80

19,17

19,17

3

Sup: 705.99 m²

42,83

21,84

4,81

2,40

20,33

42,83

Calle J.D. Perón (Pav)

8,65

8,65